

Australian Capital Territory

## **Public Roads (Hume) Declaration 2011 (No 1)**

**R46/11**

**Notifiable instrument NI2011-701**

made under the

**Public Roads Act 1902, section 18 (Lands reserved as roads may be  
declared public roads)**

---

I declare that the land described below shall be a public road.

Bill Hirst  
Surveyor-General of the ACT  
Delegate of the Minister

Date: 15 November 2011

The land adjacent to the Monaro Highway and Blocks 14, 16 and 17  
Section 18 in the Division of Hume, in the District of Jerrabomberra, shown  
in thick black lines on the plan annexed hereto.

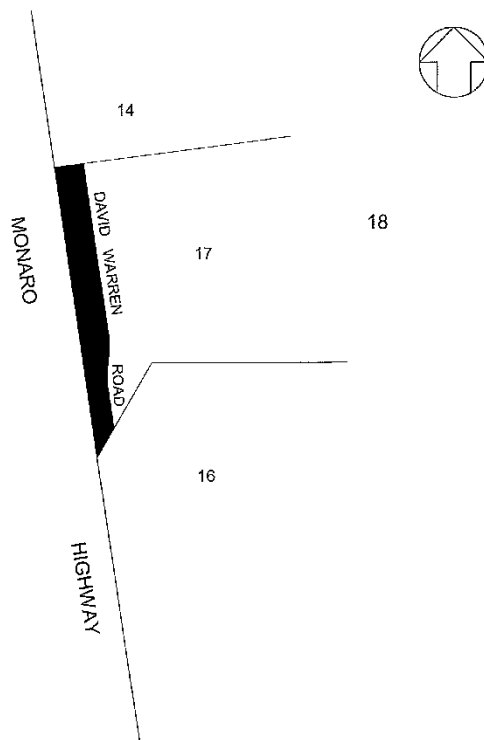

ROAD OPENING

## DIVISION OF HUME

This is the plan annexed to Public Roads (Hume) Declaration 2011 (No 1) signed on  
 this 15<sup>th</sup> day of November 2011.

  
 Delegate's Initials