

Australian Capital Territory

Public Place Names (Strathnairn) Determination 2018*

Disallowable instrument DI2018–99

made under the

Public Place Names Act 1989, s 3 (Minister to determine names)

1 Name of instrument

This instrument is the *Public Place Names (Strathnairn) Determination 2018*.

2 Commencement

This instrument commences on the day after its notification day.

3 Revocation

This instrument revokes *Public Place Names (Belconnen District) Determination 2011 (No 1)* DI2011-184.

Note: By revoking this instrument, the public place name Studio Road in the Belconnen District is revoked as the area will no longer be used as a road due to road realignments.

4 Amendment of Place Name

I amend the determination published in Commonwealth of Australia Gazette No. P9 dated 4 June 1982 as specified in Schedule 1 and as indicated on the associated diagram.

5 Determination of Place Names

I determine the place names as indicated in Schedule 2.

Ben Ponton
Delegate of the Minister
21 May 2018

*Name amended under Legislation Act, s 60

SCHEDULE 1
(see Clause 4)

NAME	DISTRICT	INSTRUMENT	AMENDMENT
Stockdill Drive	Belconnen	Commonwealth of Australia Gazette No.P9 dated 4 June 1982, Schedule 'A' and the associated map	Revoked to the extent described as the portion of Stockdill Drive between its intersection with Drake Brockman Drive and the road intersection leading to the Lower Molonglo Water Quality Control Centre.



Schedule 1

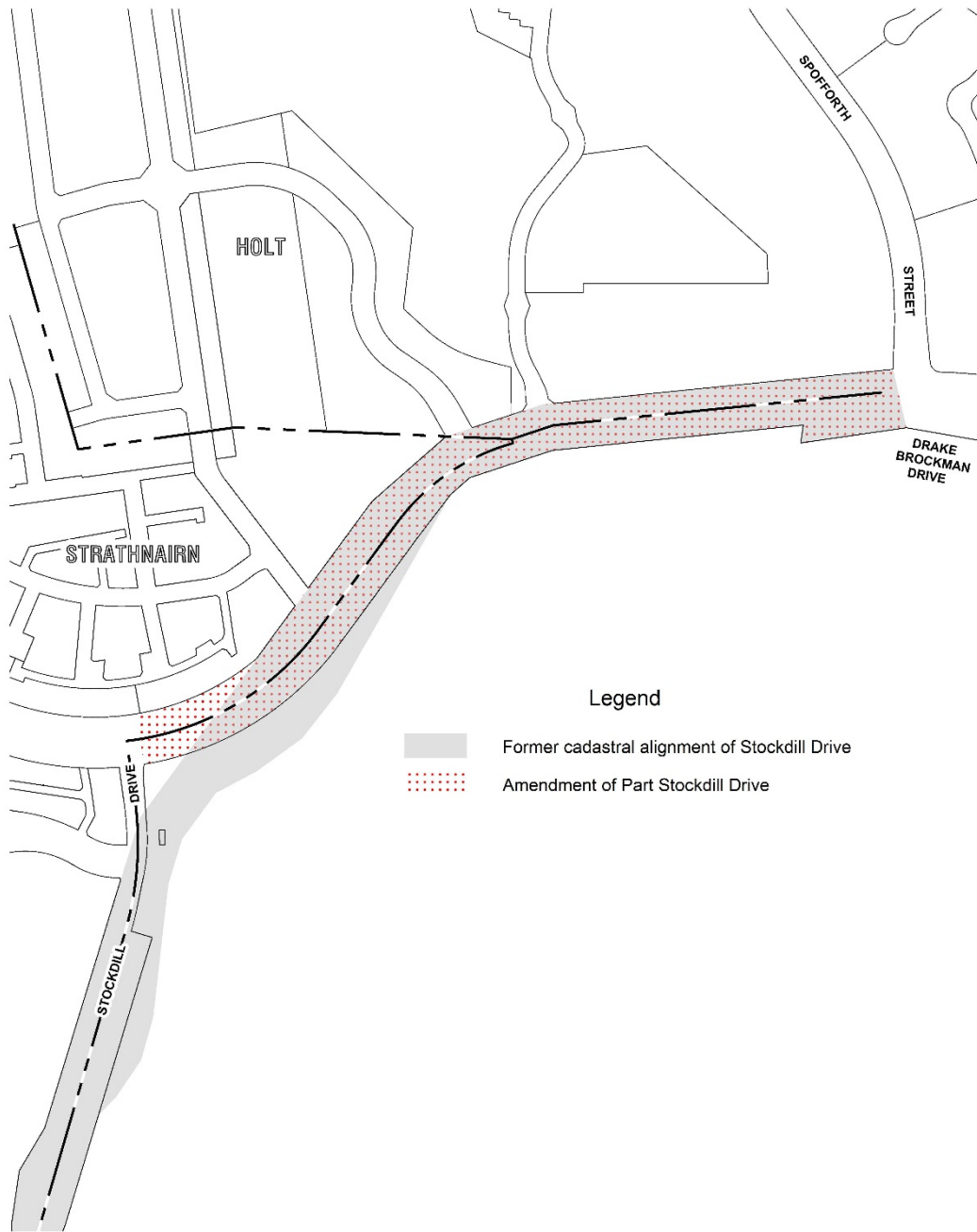

DISTRICT OF BELCONNEN
Diagram

SCHEDULE 2
(See Clause 5)

Division of Strathnairn – Primary Industry and Regional Service

The location of the public places with the following names is indicated on the associated diagram.

NAME	ORIGIN	SIGNIFICANCE
Ariotti Street	Dr Louis Charles Anthony Ariotti MBE OAM (1915–2008)	Surgeon in rural health Dr Lou Ariotti made a significant contribution to rural health services in Queensland. He graduated from Sydney University with a desire to practise medicine in rural Australia. In 1947, he purchased an established practice in Charleville, south-west Queensland, following service during the Second World War in New Guinea and Borneo. Ariotti was an innovative surgeon who improvised and adapted his practice to suit the needs of his patients, including pathology and radiography services. His expertise in surgery, including urology, orthopaedics, neurosurgery, paediatrics, vascular, ear nose and throat, as well as acupuncture, enabled patients to stay in Charleville for their medical care. He received valuable support from his first wife, Muriel. Dr Ariotti helped form the Rural Doctors Association of Queensland in 1989 and was appointed its first patron. He was appointed a Member of the Order of the British Empire in 1977 and in 1993, awarded the Medal of the Order of Australia. His autobiography, <i>The guiding hand with the Lord at the helm: memoirs of an outback GP and surgeon</i> , was published in 2008.

Aubrey Lane	<p>Gertrude Olive Aubrey (1921–1982)</p>	<p>Regional service, education, college lecturer</p> <p>Olive Aubrey taught in secondary schools in Sydney and country NSW from 1940–50 and at the Presbyterian Ladies' College in Armidale, in the Northern Tablelands region, from 1955–59. She was senior lecturer in English at the Armidale College of Advanced Education (CAE) from 1959–78. Aubrey worked to develop the teaching of drama in schools and contributed to the establishment of the creative approach to teaching language and literature at the former Armidale Teachers College. She was a committee member and producer with the Armidale Musical Society from 1956–75. In 1954, she was one of the first women elected to the Maclean Municipal Council, Northern Rivers region, and was secretary of the local branch of the Country Women's Association.</p>
Blundell Place	<p>Abraham (Abram) Blundell (1847–1884)</p> <p>Phoebe Anna Blundell (nee Shumack) (1857–1943)</p>	<p>Pioneer farmers in the local region</p> <p>Abraham Blundell took up a selection of land in the Parish of Weetangera in the early 1870s. In 1877, he married Phoebe Shumack at St. John's Church. The couple worked to establish <i>Violet Ville</i>, a farm of 240 acres at Weetangera (Weetangerra), adjoining other Shumack land. <i>Violet Ville</i> covered a significant part of the present suburb of Weetangera, ACT. The first Weetangera School (1875–1937) was built on land adjoining the north-west corner of the property. Phoebe Blundell tenanted the land to other farmers following the early death of Abraham in 1884. In 1906 she issued instructions to A. W. Moriarty & Co to sell the land by public auction. The property was advertised as "...the superior and well-known farm of the late Abraham Blundell".</p>

Bonthrone Street

William Napier
Bonthrone AM MBE
(1933–2008)

Primary industry; local government; regional service

Queensland pastoralist William (Bill) Bonthrone served as councillor with Waggamba Shire Council in 1965–66 and Balonne Shire in 1970–73. He was president of St. George P & A Society in 1972–73, member of the Balonne Hospital Board and appointed a Justice of the Peace. His public service to primary industry began as president of the Maranoa Graziers Association in 1979, a position he held until 1983. His commitment continued through membership of the Wool Council of Australia during 1984–87, president of the Sheep Meat Council of Australia from 1987–90 and member of the Australian Meat and Livestock Industry Policy Council over the same period. Bonthrone served on the executive committee, and as council member, of the National Farmers' Federation in 1987–94 and president of the United Graziers' Association of Queensland from 1990–94. He was appointed a Member of the Order of the British Empire in 1989, and a Member of the Order of Australia in 1996, for service to primary industry and the rural community.

Boxall Lane

Priscilla Mary
Boxall OAM
(1921–2008)

Regional service

Priscilla Boxall provided long and valuable service to welfare and aged care organisations within the community of Kangaroo Island, South Australia. She contributed to the Country Women's Association for over 50 years and was awarded life membership in 1970. Boxall served the Meals on Wheels program for over 25 years and contributed to the Kangaroo Island Community Forum and the Disability Advocacy and Action Group. Boxall held various offices in Kingscote Uniting Church Council and Women's Fellowship Group and was a board member and treasurer of the Boronia Village Retirement Cottages. She was an office bearer, exhibitor and judge for the Kangaroo Island Agricultural and Horticultural Show over a long period. In 2005, she was awarded the Medal of the Order of Australia for service to the community of Kangaroo Island, particularly through welfare, service and aged care organisations.

Clegg Lane

William Ronald
Clegg MBE OAM
(1929–2013)

Regional service; local government

Bill Clegg was elected to Gunnedah Municipal Council in NSW in 1956, serving as deputy mayor for five terms and mayor from 1969–80. In 1980, he was founding president of the amalgamated Gunnedah Shire Council. He retired in 1999 after 43 years continuous service to local government. Clegg was Namoi division controller for the State Emergency Service (SES) from 1969–88, co-ordinating the valley response to a series of major floods through the 1970s. He helped found the North West Tourist Association in 1963 and served on the executive of the NSW Council of Regional Tourist Associations. In 1983, he received the Rod Murdoch Award for services to tourism and, in 1989, was honoured with life membership of the NSW Tourist Association. In 2000 the new headquarters of the SES and Rural Fire Service in Gunnedah was named in his honour. Clegg was awarded the Medal of the Order of Australia in 2002 for service to the community of Gunnedah through local government, and to the development of tourism in the area.

Cudmore Court

Desmond Michael
Cudmore AM
(1932–2012)

Rice industry; regional service

Desmond Cudmore was appointed a Member of the Order of Australia in 2009 for service to agriculture as a rice grower, through industry organisations, and to the community of the Riverina in NSW. He was a member of the Ricegrowers' Association of Australia from 1947; director, Ricegrowers' Co-operative Ltd trading as SunRice (formerly known as Ricegrowers' Co-operative Mills Ltd), from 1985–97 and Chairman, Rice Marketing Board, New South Wales from 1985–89. Cudmore served the regional community of Riverina across a range of organisations including the Griffith District Cricket Association, the Murrumbidgee Cricket Council and the Rotary Club of Griffith. He was Secretary of the Warburn Bush Fire Brigade from 1956–95 and Councillor, Wade Shire Council from 1970–77.

**Fairbrother
Street**

Dr Jeffory Graham
Fairbrother AM
(1934–2015)

Poultry industry; food technology

Jeff Fairbrother made a significant contribution to the poultry industry through research and advisory roles, and the development of regulatory policies on animal health and welfare, food safety standards, quarantine and biosecurity. He graduated from the Royal Military College, Duntroon in 1954 and studied to attain a Bachelor of Science with first-class honours in Food Technology from the University of New South Wales. In 1958, he was appointed to the Army Food Research Laboratories in Tasmania, developing food ration packs. In 1964, Fairbrother was awarded a scholarship to study in the USA and gained his PhD in Food Science and Technology. In the late 1960s he held senior roles in the Commonwealth public service including Secretary of the Food Standards Committee, National Health and Medical Research Council and Director of Food, Department of Trade and Industry. He was Executive Director of the Australian Poultry Industries Association and the Australian Chicken Meat Federation from 1969–2010 and founding Chair of the Australian Poultry Cooperative Research Centre, based at the University of New England, from 2003–10. Fairbrother was appointed a Member of the Order of Australia in 2008.

Ferrari Court

Marie-Martine
Ferrari

(1948–2013)

Regional service; artistic director; puppeteer

Marie-Martine Ferrari contributed to the arts and entertainment in regional communities of Australia through her puppetry, visual-based theatre and workshops. In her early career she performed under the pseudonym *Papillion*. She lived in Braidwood, NSW in the early 1980s and became involved with Blue Folk Community Arts at Strathnairn Homestead. Ferrari co-founded the Skylark Puppet and Mask Theatre company in Canberra in 1984, gaining national and international recognition for productions often featuring strong social messages for children. Skylark collaborated with Jigsaw Theatre Company, both within schools and for the general public. The National Campaign Against Drug Abuse supported Skylark's *Inside Out* project as a tool to fight drug abuse and funded promotion of the programs to reach as many children as possible. The company was appointed Artists in Residence at the Canberra Theatre in 1988 and the Playhouse in 1989.

Marie-Martine co-founded and toured with Ferrari Puppets in Victoria from 1993–2000 and in 2001, moved to Queanbeyan to work with The Canberra Institute of Technology teaching puppet, mask and muppet-making to adults. In 2005, she co-founded a new company, Theatre of the Sun, in Railton, Tasmania.

Folvig Close

Dorothy Anne
(Wendy) Folvig
OAM
(née Finch)
(1920–2015)

Community service; primary industry

Wendy Folvig's strong commitment to rural community service was fostered throughout her childhood and adult life living on the pastoral property, *Yeelirrie Station*, south-east of Wiluna in the east Murchison region of Western Australia. In 2013, she was awarded the Medal of the Order of Australia for service to the community through a range of organisations including the Country Women's Association (CWA), the National Trust of Australia (WA) Council, the State Emergency Service, the Pastoralists and Graziers Association of WA and the Wiluna Hospital Board. Folvig joined the CWA in 1951 and was awarded Honorary Life Membership in 1994. She advocated for improvements to education, communication and medical services for rural families, serving the CWA as president and secretary of pastoral and metropolitan branches; delegate at national and international conferences; representative to the National Trust of Australia (WA) Council (1991–94) and editor, *The Countrywoman of Western Australia*. She volunteered more than 10,000 hours to the National Trust in various roles and was honoured with Life Membership in 2009. A book about her life, *Yeelirrie: Wendy's Place*, was published in 2014.

Gullifer Street	<p>Pamela Ann Gullifer AM (1937–1995)</p>	<p>Arts administrator and curator; regional service</p> <p>Pamela Gullifer advocated to promote regional art galleries in Victoria and to offer opportunities for diverse temporary exhibitions. In 1968, she was on the steering committee to establish the Ararat Gallery, serving as the voluntary Exhibitions Officer from 1969. She was appointed founding director of the gallery in 1973. Under her direction Ararat Gallery established a textile and fibre art specialisation and in 1975, mounted <i>Woolworks</i>, to promote excellence and innovation in textile fibre art, the first exhibition of its type to be assembled in a regional Victorian gallery. Gullifer had an appreciation of the growing craft movement in Australia and in 1977, was appointed founding director of the Crafts Council of Australia Gallery at The Rocks, Sydney. She was director of the Geelong Art Gallery in 1980–84; The Exhibitions Gallery, Wangaratta in 1989–90 and the Benalla Art Gallery in 1990–95. Gullifer was appointed a Member of the Order of Australia in 1995 for service to art gallery administration. In 1998 Ararat Galley mounted an exhibition to celebrate her work, <i>Gullifer’s travail: an Ararat Gallery exhibition</i>.</p>
Havard Street	<p>Arthur Francis Havard OBE (1901–2001)</p>	<p>National rural leader; grazier; jackaroo</p> <p>Arthur Havard was President of the Victorian Graziers’ Association in 1955–57 and President, the National Farmers’ Union of Australia (NFU) from 1959–65. He explored ways to overcome duplication at the national level between the NFU and the Australian Primary Producers’ Union. Throughout the early 1960s he advocated for unity in the pastoral industry by pioneering negotiations between the two unions. His initiative led to his successors agreeing to establish the combined Australian Farmers’ Federation in 1969. Havard worked as a jackaroo in Queensland during the early 1920s and was appointed to his first property manager role in 1924. He went on to manage other properties including <i>Balpool</i> in the NSW Riverina. He ran his own property <i>Wuriga</i> at Cobden in Victoria during the 1930s–50s. Havard was appointed an Officer of the Order of the British Empire in 1963.</p>

Hedditch Court Mabel Emily
Hedditch OBE
(1897–1966)

Local government; community service

Mabel Flux emigrated from England to Victoria to marry First World War soldier Norman Hedditch in 1921. The couple settled on the family farm *Lal Lal* at Lower Cape Bridgewater, near Portland. Mabel Hedditch contributed to the community through foundation membership of the Portland Branch of the Country Women's Association of Victoria and later service as group president, central vice-president and in 1953–55, State president. She served on Portland Town Council in 1949–64 and was mayor during 1956–60. She was appointed a justice of the peace from 1954 and was a delegate and Life Member of the Victorian Decentralisation League. Hedditch was treasurer of the town's infant welfare centre, director of the Home Help Service, volunteer with Meals on Wheels, president of the Old Folks Welfare Committee and secretary of the Lewis Court Homes for the Aged. She was described by the Melbourne Herald as one “who knows and loves the land, the people who live on it, the things that grow in it”. Hedditch was appointed an Officer of the Order of the British Empire in 1960.

Ian Baird Lane	<p>Ian Hamilton Baird (1900–1967)</p> <p>Ellen Emily Melbourne Baird (née Fox) (1904–1997)</p>	<p>Grazier; Canberran; community service</p> <p>Ian Baird was granted the Crown lease over Block 18 Belconnen District in 1933. He moved from his father’s property <i>Birroon</i> near Gunning, NSW to establish the rural lease as a productive mixed use farm. Ian and his wife Ellen (Nel) named the property <i>Strathnairn</i>. They extended the cottage and built the woolshed and other farm buildings. The couple was active within the local community and hosted groups to investigate land management issues including soil conservation and eradication of rabbits, and entertained Australian and international dignitaries to provide an insight into rural life. Ian Baird was an executive member of the ACT Rural Lessees Association and the Canberra Sheep Dog Trials Association. During the Second World War he served in the Volunteer Defence Corps. Ellen Baird supported local charities and community groups serving as president of Canberra YWCA. The Baird family farmed <i>Strathnairn</i> until 1974 when the Crown lease was resumed by the Commonwealth.</p>
Keach Close	<p>Mary Mackinnon Keach OAM (1907–2002)</p>	<p>Sheep breeder; regional service; local government</p> <p>Mary Keach grew up on the Winton property near Campbell Town, Tasmania, where her love of sheep influenced her to establish the Roseneath Merino sheep stud near Ross in 1949–66. She sold stock at the annual Melbourne sheep sales, exhibited successfully at local agricultural shows and was an enthusiastic equestrian participator with the Midland Hunt Club. Keach was the first woman appointed to local government in northern Midlands, serving as Councillor with Ross Municipal Council from 1958–81. She contributed to health, sporting, social and aged care services in Ross and donated numerous prizes for local students. Keach was the recipient of an Honorary Life Membership of the Midland Agricultural Association (Campbell Town Show) and was awarded the Medal of the Order of Australia in 1978 for service to the community.</p>

**McClymont
Way**

Professor Gordon
Lee (Bill)
McClymont AO
(1920–2000)

Agricultural scientist; ecologist and
educationist

Bill McClymont is widely recognised for the important contributions he made to agricultural research and development, agricultural education and overseas aid programmes. In 1955 he was appointed foundation dean of the Faculty of Rural Science at the University of New England, a unique degree program integrating animal husbandry, veterinary science, agronomy and other disciplines, into the field of livestock and agricultural production. He employed a multidisciplinary approach to farm ecology by applying the principles of ecology to the integration of the technological, economic and social factors involved in sustainable systems of agriculture. McClymont published articles in academic journals on biochemistry and animal nutrition and consulted to the Food and Agriculture Organization of the United Nations, Educational, Scientific and Cultural Organization (UNESCO). Following retirement from the university in 1980, he continued to work with the agricultural industry in Australia and consult with the United Nations and the World Bank on farm issues. McClymont was appointed an Officer of the Order of Australia in 1978 for distinguished service to veterinary science and agricultural research.

**Pro Hart
Avenue**

Kevin Charles ‘Pro’
Hart MBE
(1928–2006)

Artist; regional and community service

Born in Broken Hill, NSW, Kevin Hart studied at the Broken Hill Technical College and after a period working in the Broken Hill mines, began painting fulltime in 1958. Nicknamed *Pro*, short for professor, he made a significant contribution to Australian art in the way he portrayed Australian people and places. Known for his paintings in oils and acrylics, scenes of bush life in electric blue, orange and mustard, he also made sculptures in steel, bronze and ceramics. His paintings depict the sense of space in the Australian outback, the spiritual quality, caricatures of the people and often the comedy in outback events as in *Menindee Races* (1974). His works are represented in Australian and regional galleries and many of his sculptures are installed in and around Broken Hill. Pro Hart exhibited internationally during the 1960s and 70s but was always drawn back to Broken Hill, where he established the *Pro Hart Art Gallery*, which remains a strong tourist attraction for the region. Pro was a member of the Broken Hill group the *Brushmen of the Bush*, formed to showcase the art of outback Australia and raise funds for charity. The *Pro Hart Outback Art Prize* is named to acknowledge Pro, and his family, for their contribution to the arts and support of Broken Hill.

Quintal Court	Bonnie Anne Quintal MBE (1928–2015)	<p>Registered nurse; regional service; pilot</p> <p>Bonnie Kelly arrived on Norfolk Island in the early 1950s to nurse at the Norfolk Island Public Hospital and married George ‘Kik’ Quintal in 1953. She later obtained a restricted Private Pilot’s Licence and during the 1970s–80s, chartered light aircraft to fly around Australia and across parts of the United States to fundraise for the Norfolk Island nursing service and hospital. In 1983, Quintal was appointed the foundation Divisional Superintendent of the Norfolk Island St. John Ambulance Division, carrying out the role with dedication over a period of 25 years. She coordinated the local volunteer ambulance service and trained volunteers in Senior First Aid. Quintal was awarded a Churchill Fellowship in 1985 to investigate disaster preparation and planning in remote communities. She was admitted in 1988 as a Serving Sister to the Order of St. John, created an Officer in 1994 and made Commander in 2003. In 2008, the Norfolk Island Philatelic Bureau featured Quintal on the First Day of Issue cover to honour the Silver Jubilee of St. John Ambulance in Norfolk Island.</p>
Tinetti Close	John Henry Tinetti OAM (1920–2013)	<p>Regional service</p> <p>Jack Tinetti served the Kalgoorlie community in Western Australia for almost 60 years after founding the Goldfields Aged Pensioner's Association (GAPWA) in 1954. He worked tirelessly to raise funds to assist people in the regional community. Tinetti was awarded the Medal of the Order of Australia in 1996 for service to aged people through the Goldfields Aged Pensioners' Welfare Association and received the Centenary Medal in 2001 for service to aged care through the development of facilities. In 2006, he was named <i>Goldfields Senior of the Year</i> for his dedication to improving the welfare of seniors. He continued to raise funds and distribute cheques until mid-2013 as part of GAPWA's biannual winter fuel subsidies for heating and firewood for pensioners.</p>

Tredwell Street	Robyn Maureen Tredwell (1950–2012)	<p>Rural women's leader; ecologist; farmer and nurse</p> <p>In 1995, Robyn Tredwell was selected as <i>ABC Australian Rural Woman of the Year</i>, in recognition of her contribution to knowledge about sustainable land management and agriculture in the Kimberley region of north-western Australia. Tredwell managed <i>Birdwood Downs</i> station near Derby, on the Gibb River Road, for an ecological foundation concerned with savannah lands. From 1985, she worked alongside others to successfully apply an ecological approach to sustainable land care on the property, improving degraded lands using stock management, weed control and planting improved grasses. She ran a TAFE course in rural operation for local Aboriginal people, in addition to her ecological work. Tredwell recognised the significance of the arts to regional communities and hosted workshop programs with indigenous and overseas artists, including the Triangle Artists Workshop, to bring Aboriginal artists, together with San Bushmen from the Kalahari in Africa, to create collaborative artistic works.</p>
------------------------	---------------------------------------	---

Yeomans Street	Percival Alfred Yeomans (1905–1984)	Agriculturist; mining engineer; ecological pioneer; writer P.A Yeomans conceived the Keyline System of land management based on the principles of soil improvement, erosion control, water storage, cultivation and irrigation. During the 1940s–50s, he conducted trials on two grazing properties in the Richmond district, NSW and investigated the principles and practice of chisel ploughing and mapping of the ridge contours, or keylines. He applied a whole-system approach to sustainable design and management of the landscape to improve soil fertility and minimise erosion. Yeomans developed new methods and equipment for levelling, deep soil ripping and contour ploughing. He established an integrated business framework to consult, lecture and write about keyline planning and manufacture cultivation equipment. In 1974, the Industrial Design Council of Australia awarded P. A Yeomans Pty Ltd the Prince Philip Prize for its innovative plough, the Bunyip Slipper Imp with Shakaerator. His publications include <i>The Keyline Plan</i> (1954), <i>The Challenge of Landscape: the development and practice of Keyline</i> (1958), <i>The City Forest: the Keyline Plan for the Human Environment Revolution</i> (1971) and <i>Water For Every Farm</i> (1978).
-----------------------	---	--

Yoornie Way

Yoornie
The traditional name
of Vivienne Clara
Karahoutis
(nee Smith)
(1958–2011)

Noongar woman; regional service; advocate for
Indigenous people

Yoornie is the traditional Noongar name of Vivienne Karahoutis. Yoornie provided strong leadership in the Manjimup community in south-west Western Australia and was committed to advancing Aboriginal health and connecting people to services. She advocated for inclusiveness and for programs which involved the entire community. Yoornie was influential in many caring for country, heritage and archeological projects in the region, providing important evidence and connection to culture and country for the community. She re-established the Walgenup Aboriginal Corporation to provide leadership and programs for people living in the Manjimup Shire. She was a founding member of the Making Schools Country Initiative and regional representative on the South West Aboriginal Medical Service Board. She served on the Manjimup Timber Park Committee, the Manjimup High School Council, the Warren Blackwood Human Services Committee, the District Aboriginal Education Advisory Council and the Manjimup Land Conservation District. An outstanding Indigenous achievement award is presented annually in her honour to a graduating student of Manjimup Senior High School.



Schedule 2
(see Clause 5)

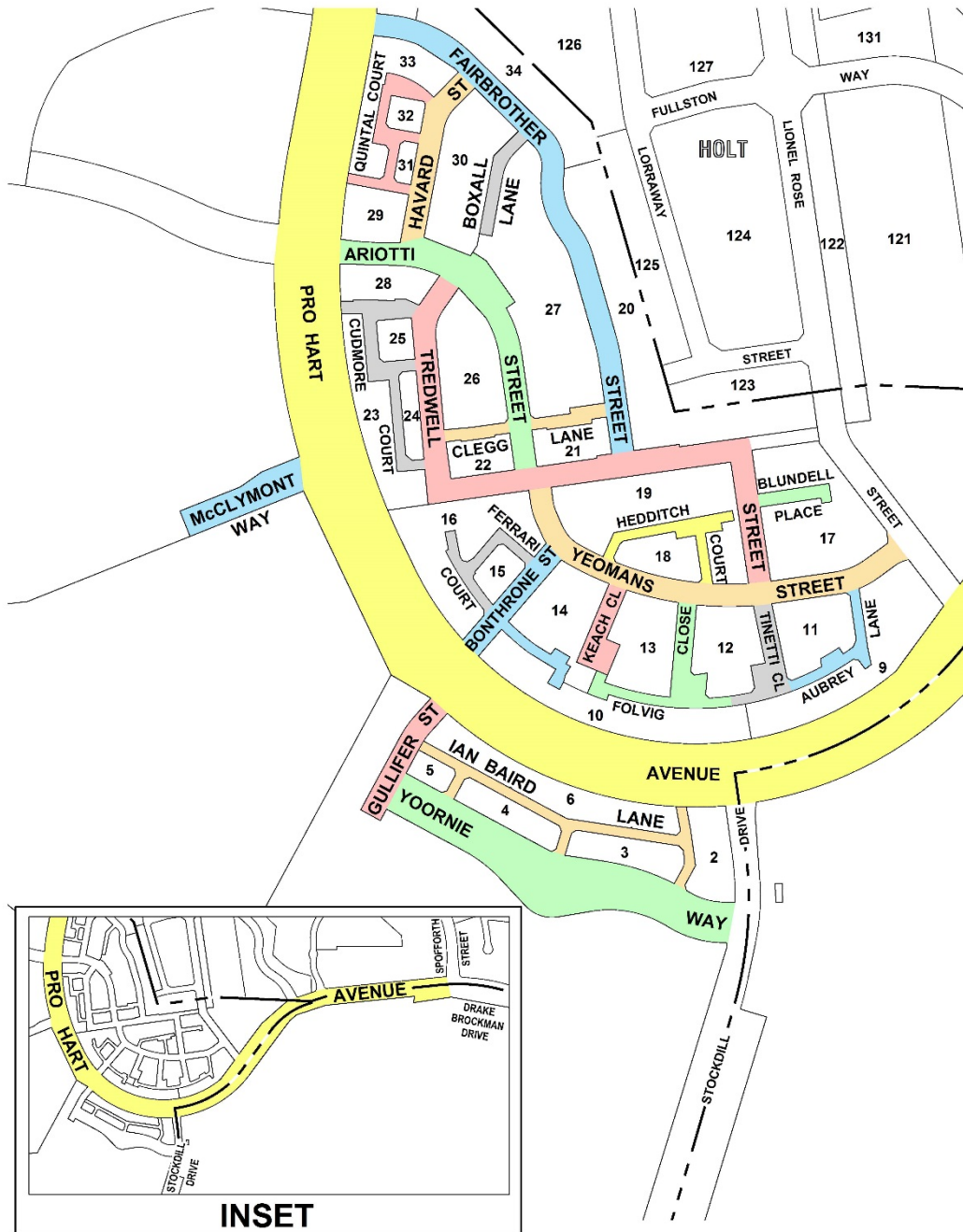

DIVISION OF STRATHNAIRN
Diagram