

No. S19, Friday 4 May 1990

PUBLIC ROADS ACT 1902 OF THE STATE OF NEW SOUTH WALES
IN ITS APPLICATION TO THE AUSTRALIAN CAPITAL TERRITORY
NOTICE OF INTENTION TO CLOSE A PUBLIC ROAD

Under section 19 of the Public Roads Act 1902 (NSW) in its application to the Territory, I NOTIFY that I am of the opinion that it is expedient to close the roads described in the schedule to this notice. Any interested person who wishes to object to the closure of the roads may do so within one month of the publication of this notice by setting out any objections in writing addressed to:

Trevor Kaine, Chief Minister, care of:

First Assistant Secretary
Development Division
PO Box 158
CANBERRA CITY 2601

Attention: Anne McGrath

or hand deliver to:

Trevor Kaine, Chief Minister, care of:

Anne McGrath
ACT Land and Planning Information
220 Northbourne Avenue
BRADDON ACT 2601

Date:

27 April 1990



HANS ERNST SOMMER
The person for the time being holding
or performing the duties of the Office of
Senior Executive Level 3 Position No.5244
Office of Industry and Development.
Delegate of the Chief Minister.

SCHEDULE

All that land in the Australian Capital Territory being New South Wales crown road reserve within the parcel boundary of Block 51 in the District of Coree shown in a thick black line on plan number 1 annexed hereto; and a New South Wales road reserve within parcel boundaries of Block 99 in the District of Tennent shown in a thick black line on plan number 2 annexed hereto; and part of the old alignment of the Monaro Highway road reservation in the District of Tuggeranong shown in a thick black line on plan number 3 annexed hereto; and part of the part of the road 30.48 wide along the southern boundary of Block 64 in the District of Majura and shown in a thick black line on the plan number 4 annexed hereto - this section of road has been included as part of the area of Canberra Airport, an alternative road has been constructed and open to the public along the northern boundary of Canberra Airport as shown in hatched on the plan number 4 annexed hereto.

This is the Schedule to the Instrument executed on this
27 day of April 1990.

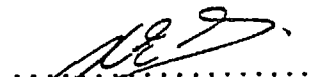
.....
Delegate's Initials

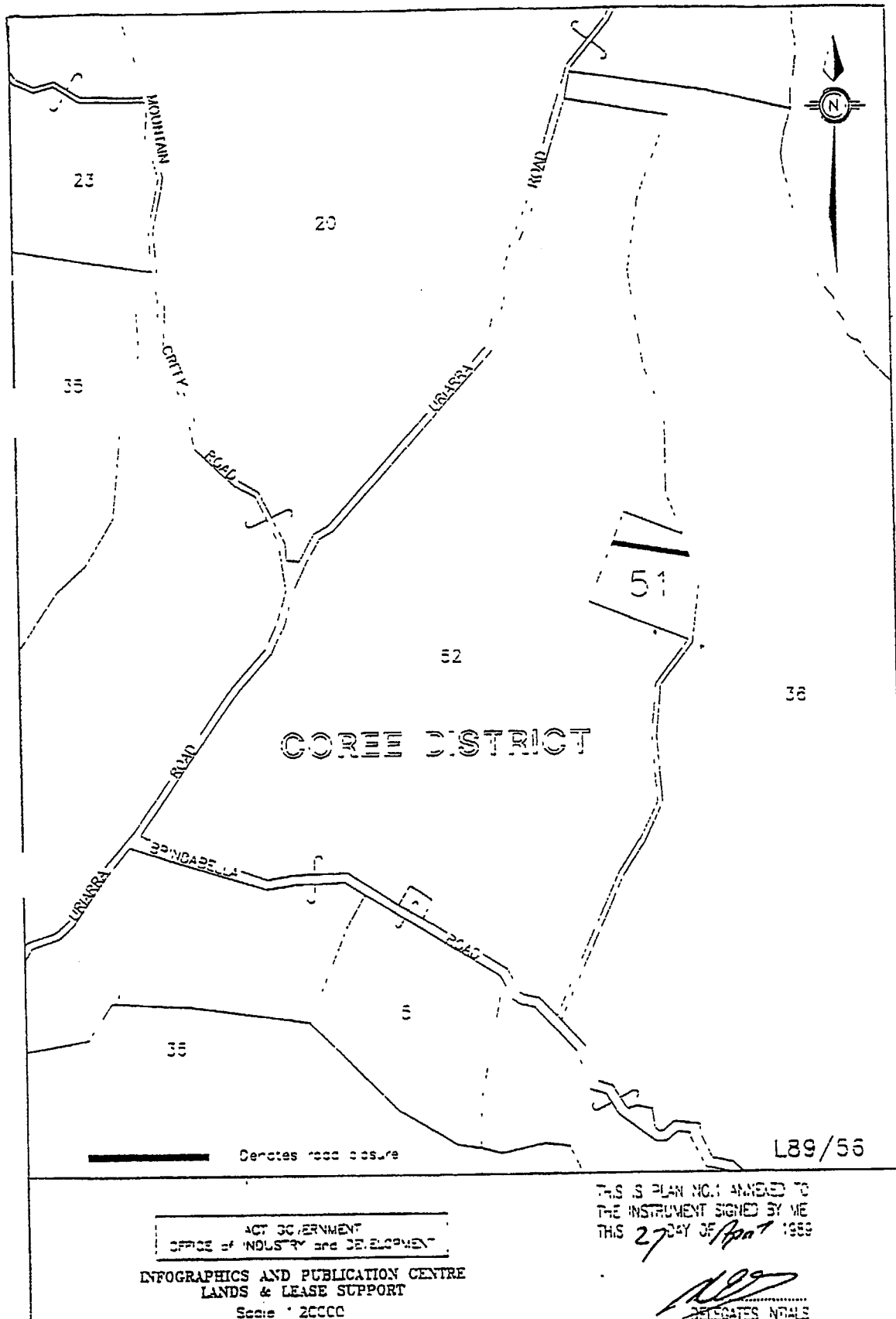

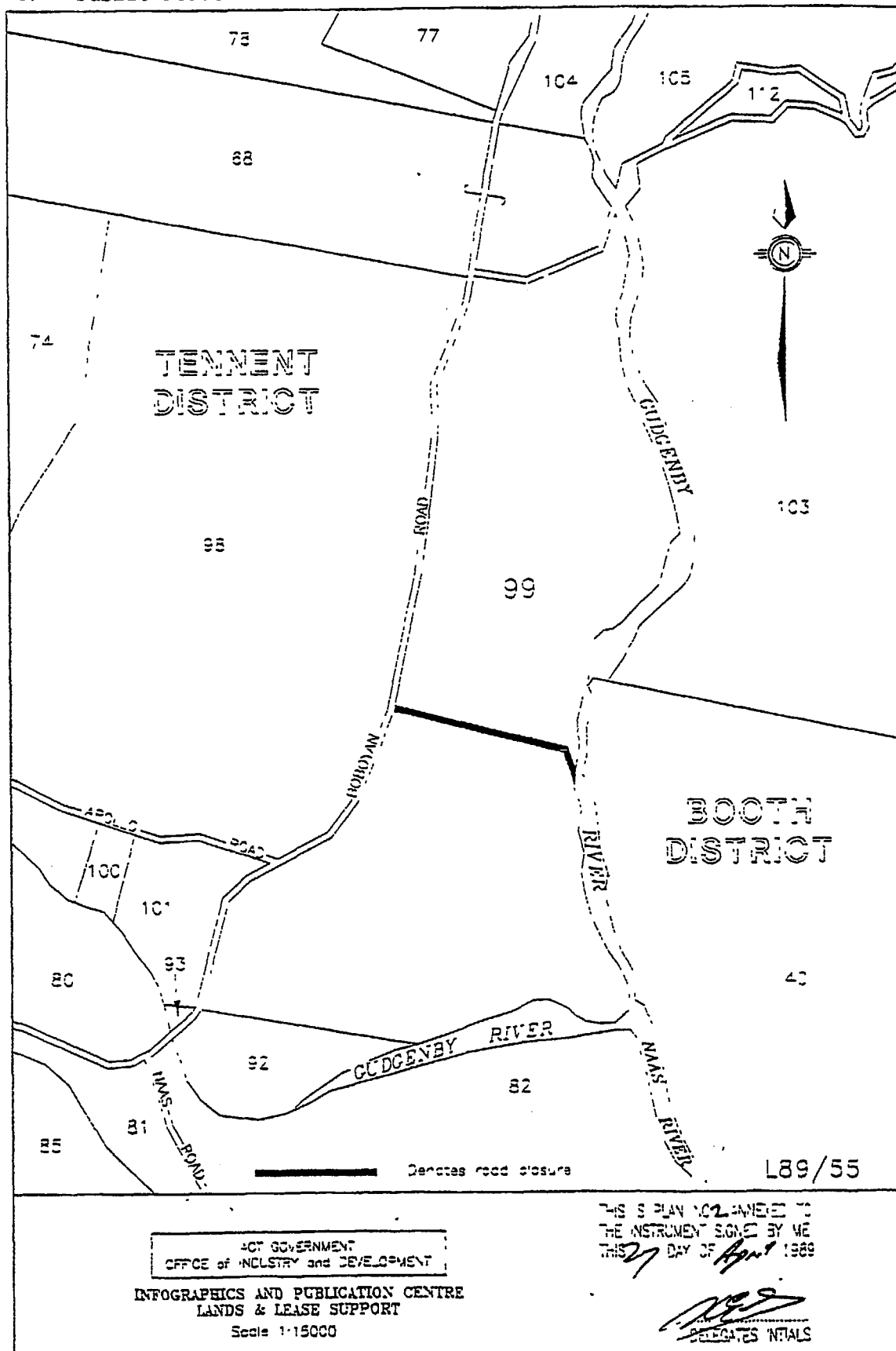

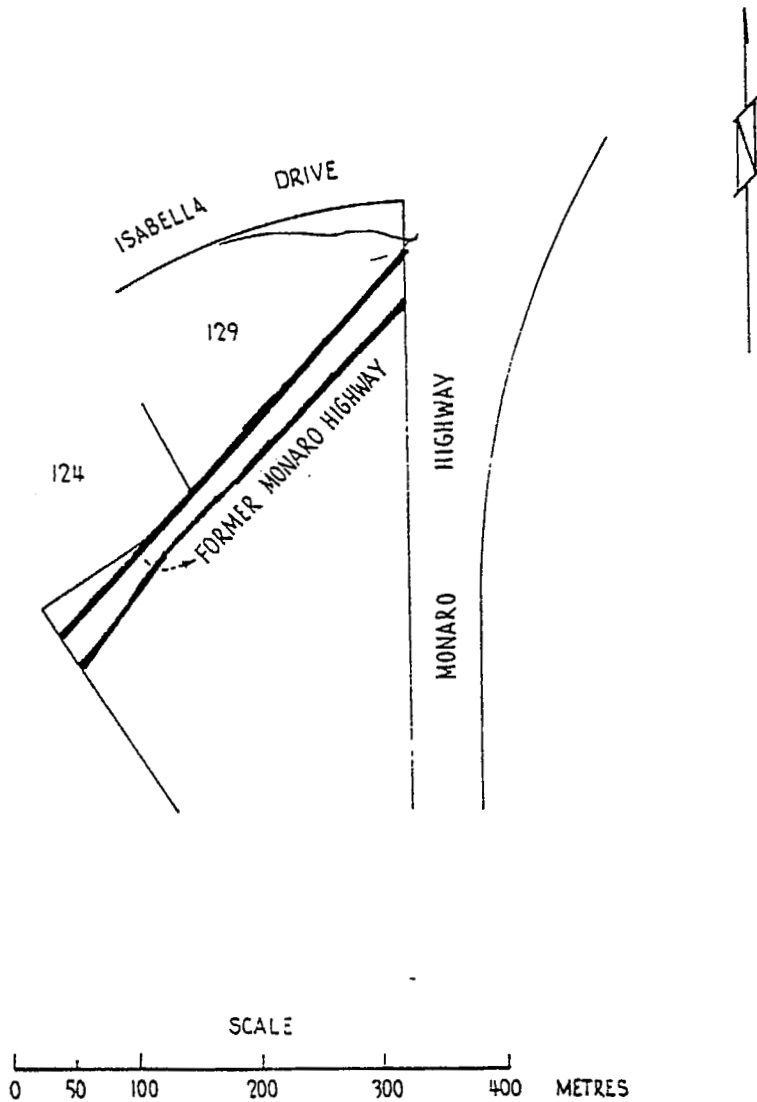

THIS IS PLAN NO 3 ANNEXED TO
THE INSTRUMENT SIGNED BY ME
THIS 27 DAY OF April 1989

[Signature]
DELEGATES INITIALS

MISC 738

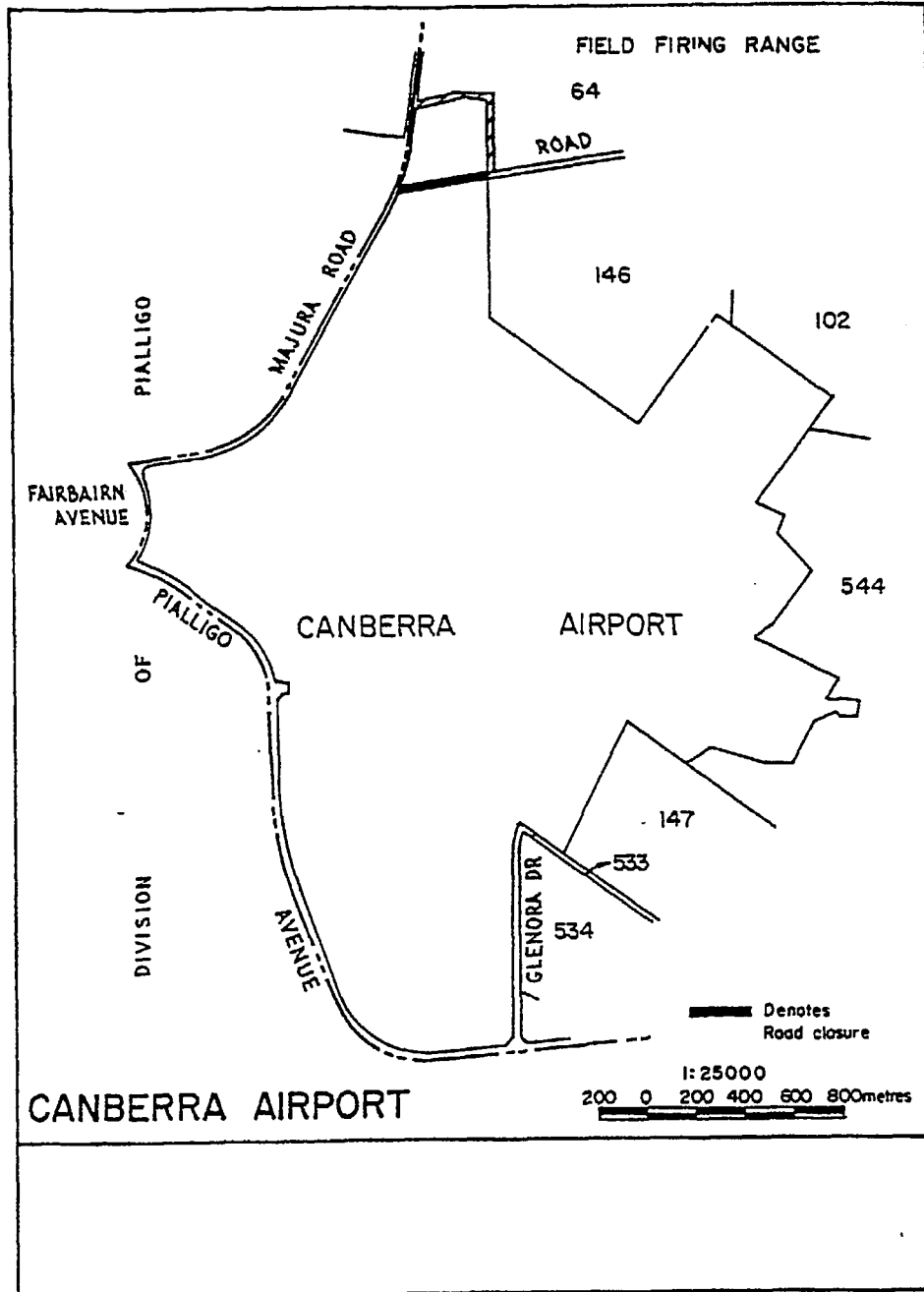

ACT GOVERNMENT
OFFICE of INDUSTRY and DEVELOPMENT
INFOGRAPHICS AND PUBLICATION CENTRE
LANDS & LEASE SUPPORT
Scale 1:25000

THIS IS PLAN NOT ANNEXED TO
THE INSTRUMENT SIGNED BY ME
THIS 27 DAY OF MAY 1990

[Signature]
DELEGATES MP/ALS