

No. S23, Friday 18 February 1994

INSTRUMENT NO. 7/94

**PUBLIC ROADS ACT 1902 OF THE STATE OF NEW SOUTH WALES
IN ITS APPLICATION TO THE AUSTRALIAN CAPITAL TERRITORY
NOTIFICATION OF ROAD CLOSURE**

Under section 20 of the Public Roads Act 1902 (NSW) in its application to the Territory, I close the road described in the schedule to this Notice.

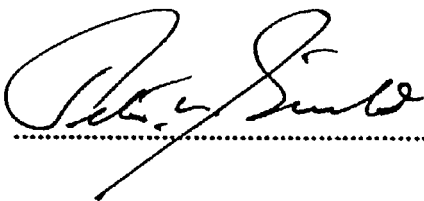

.....

DATE 15 February 1994

PETER NOBLE GUILD

The person for the time being
holding or performing the duties
of the Office of Senior Executive
Band 2 Position No 5244, Land Division,
Department of the Environment, Land and
Planning, Delegate of the Minister.

SCHEDULE

All that land in the Australian Capital Territory, shown hatched on the plan annexed hereto:

Plan No. 1: The road known as Clarence Place in the Division of Gordon in the District of Tuggeranong.

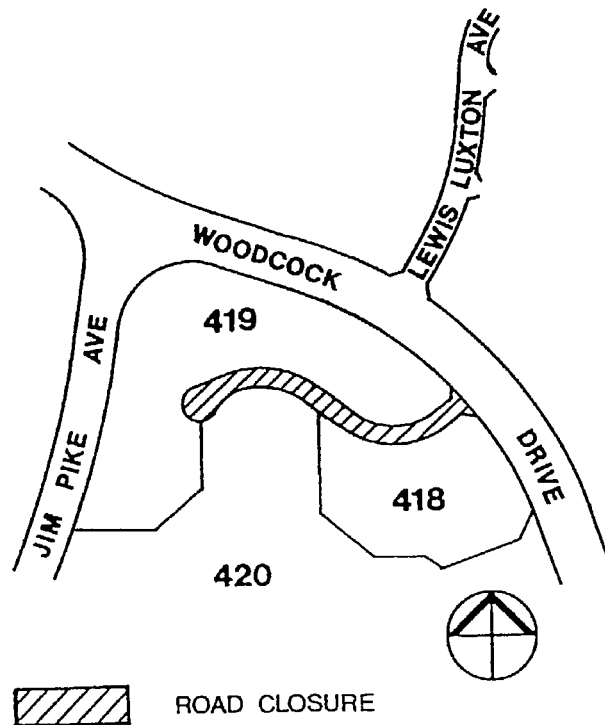

DIVISION OF GORDON

This is Plan Number One annexed to Instrument No. 7/94 signed on this *15th* day of *February*, 1994.

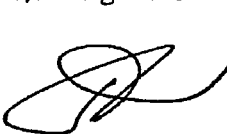
.....
Delegate's Initials

Note : The closure is of a road that has never been constructed and is not required as part of a new development.