

SECTION MASTER PLAN

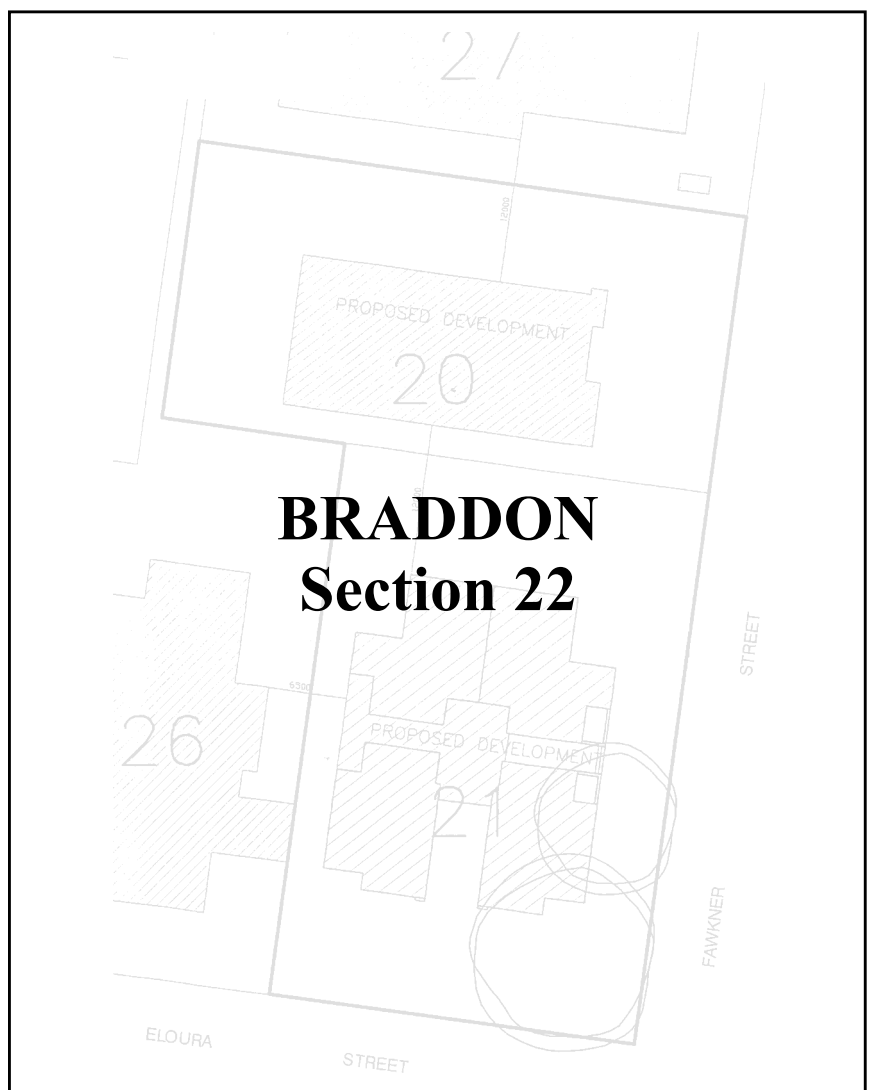

SMP No. 99/8939



Planning and Land Management
February 2000



CONTENTS

INTRODUCTION.....	3
Background	3
Implications of the section master plan.....	3
Statutory basis.....	4
Effect.....	4
Interpretation	4
CONTEXT	5
Public amenities.....	5
Street pattern and indicative traffic volumes.....	6
Heritage issues.....	8
ANALYSIS	9
Relationship to Existing LAPAC, Community Value Statement	9
Existing Configuration	10
Existing vegetation.....	11
Existing hydraulic services & electrical supply	12
Existing driveways, footpaths and street parking zones.....	13
Block and street dimensions	14
Known lessee information	15
IMPLEMENTATION	16
Control Plan	16
Development outcome drawing	20
Required improvements to public and private areas	21

Housing type guidelines	- Attachment A
Architectural guidelines	- Attachment B
Urban design principles	- Attachment C

INTRODUCTION

The Section Master Plan is a plan to complete the incremental renewal of Section 22, Braddon (Residential Area B11). The Section Master Plan is required before an application for residential redevelopment (other than for single houses and dual occupancies) can be approved in these areas.

Background

Over the last two years the Planning and Land Management (PALM) has undertaken a number of studies of the inner North Canberra B1 Area. These studies have included input from professional associations, the Ministers Urban Design Advisory Committee, the development and construction industries, individual lessees and residents, resident associations in inner North Canberra and Local Area Planning Advisory Committees. In addition, a separate and comprehensive investigation of all residential codes and guidelines (the ACT Code Review) is underway. The first outcome of that review process was Variation to the Territory Plan No:109 which establishes new redevelopment areas and policies for selected parts of inner north Canberra.

The Standing Committee on Planning and Environment, of the ACT Legislative Assembly, reinforced the need for section master plans in their report to the Assembly (November 1997). The Committee recommended that section master plans should be prepared for B11 and B12 areas of North Canberra in consultation with the community. In particular, this Committee recommended that PALM be responsible for the preparation of section master plans.

Section master plans may be reviewed at any time in the future, however any amendment would be subject to the same public consultation and approval process as required in preparing the original section master plan.

Implications of the section master plan

The section master plan will assist:

- lessees who do not wish to redevelop to contribute to the planning framework for their section
- developers in understanding the requirements for retaining residential amenity on their proposal.

In particular, the section master plan addresses issues for blocks where lessees are:

1. considering redevelopment at some time in the future, and are not opposed to the adjoining lessee maximising their development opportunities consistent with the approved section master plan - such lessees may support the adjoining lessee building to the side boundary (ie a designed and constructed future shared wall), consistent with the Control Plan.
2. not considering redevelopment of their block in the foreseeable future and wish to retain their amenity - this will mean that adjoining lessees will need to have particular regard to overshadowing, overlooking, setbacks, landscape retention etc. In such cases both lessees are unlikely to achieve the maximum redevelopment potential from their properties (eg.

Statutory basis

Under section 8 of the *Land (Planning and Environment) Act 1991* (the Act) the Territory, the Executive, a Minister or a Territory authority shall not do any act or approve the doing of any act that is inconsistent with the Territory Plan. Following the approval/gazettal of the draft Variation to the Territory Plan No.109 a consequential Executive Direction under s.37 of the Act was published in the Gazette of 20 July 1998. In response Planning and Land Management prepared a Practice Direction (No.6/98) establishing the procedure for the drafting, notification and approval of Master Plans.

The Territory Plan specifies, in relation to the B11 and B12 areas, that multi-unit development consisting of more than two dwellings shall be in accordance with an approved Section Master Plan.

Effect

In considering a proposal for multi-unit development for more than two dwellings in the B11 and B12 Areas, PALM will assess the development against the relevant approved Section Master Plan for the area (as provided for by section 2.2, Part A3 of the Territory Plan).

In assessing dual occupancy proposals, any existing approved Section Master Plan for that area will be treated as a matter for consideration under Part 1.1 (t) of Appendix I of the Territory Plan.

Interpretation

Specific provisions of the Implementation section of the Section Master Plan are considered “*Acceptable Standards*” under the Code. The Acceptable Standards are the standards considered to satisfy the relevant “*Performance Criteria*” so that, generally, no further evidence of performance is required.

Unless the contrary intention appears, strict compliance with the provisions of the implementation Section of this Master Plan is not required, provided the Proponent can demonstrate to the satisfaction of the relevant authority that the proposal will substantially comply with the intention of this Master Plan. Only formal and minor deviations from a strict interpretation of the Master Plan will be considered.

CONTEXT

Public amenities

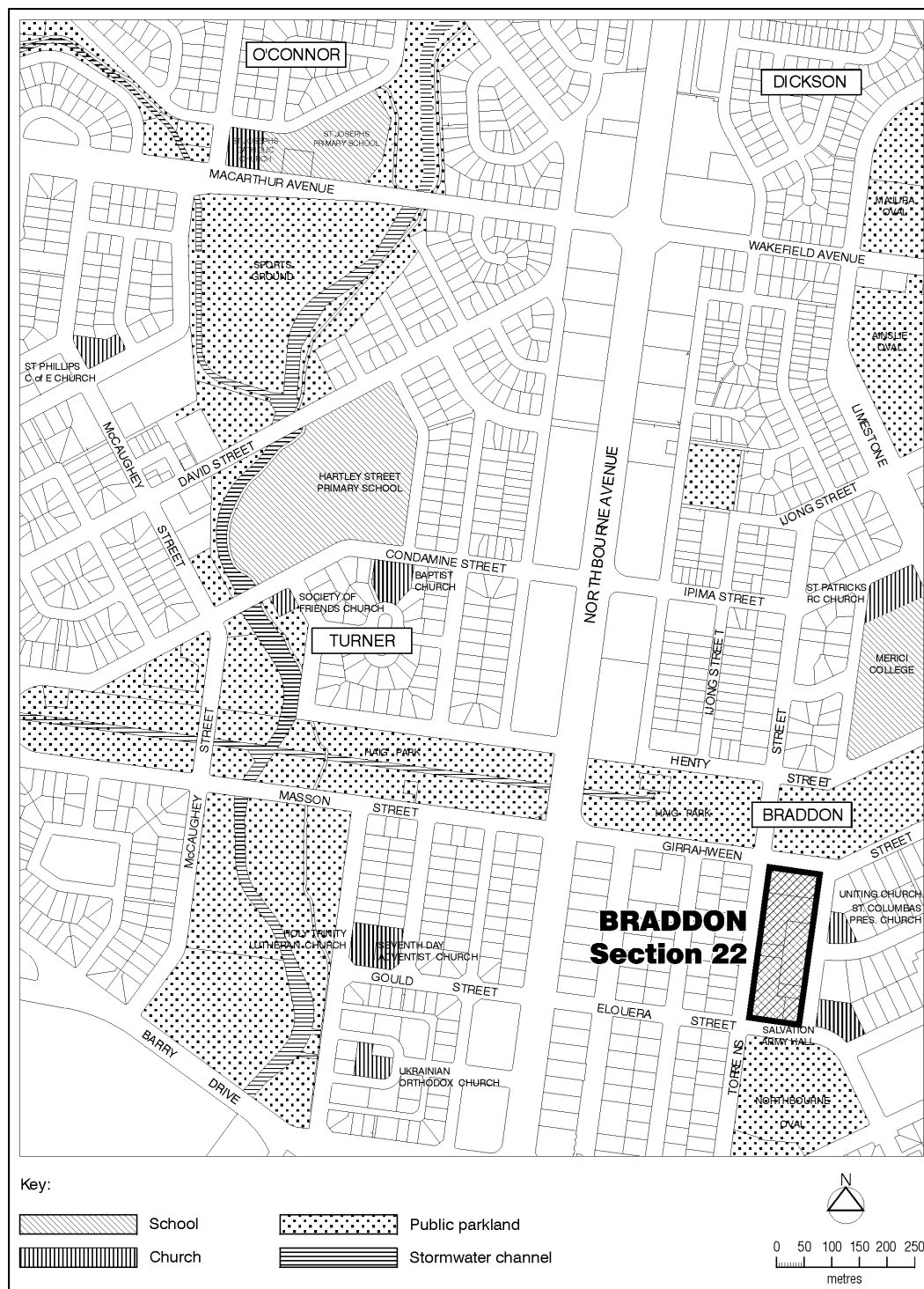

The major immediate public amenities in this area are Haig Park (north), Rugby League Park, Northbourne Oval (south), Braddon mixed services area (west) and a mix of multi-dwelling developments and community facilities (east). Civic commercial area is located approximately 300 metres to the south.

Street pattern and indicative traffic volumes

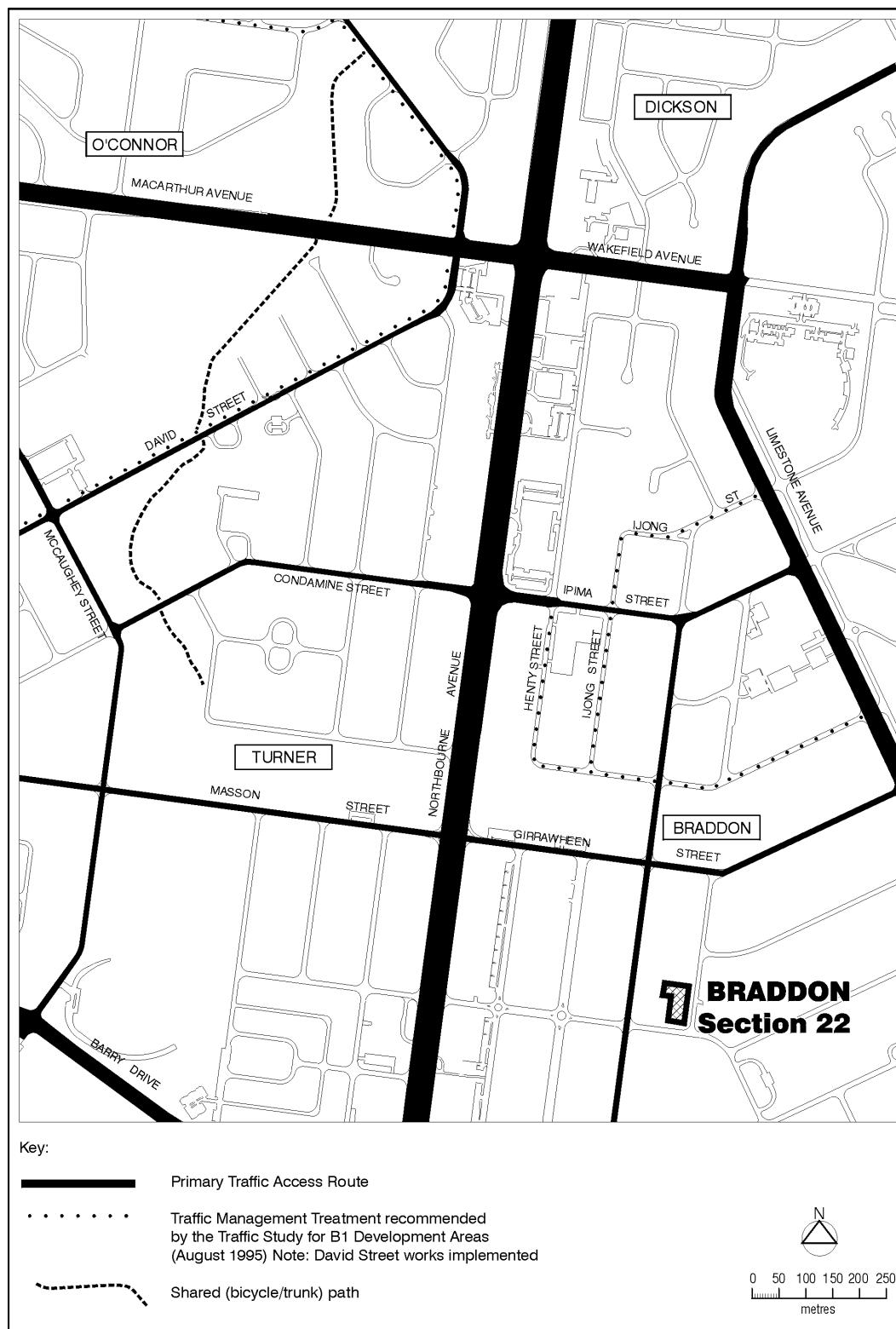

The ACT Government policy to implement the B11 and B12 Area Specific Policy is based, in part, on good existing traffic management and road infrastructure. This is documented in:

- “*Having a Say*” - Report on community consultation on the Gungahlin External Travel Study: Lansley, Hayes and Storer Pty Ltd (1989)
- Northbourne Avenue Traffic Management Strategy: Arup Transportation Planning (1995)

- Traffic Study for B1 Development Areas North Canberra: Arup Transportation Planning (1995)
- Mouat/Ginninderra Drive Review: R J Nairn and Partners Pty Ltd et al (1996)
- Series of recent local area traffic management (LATM) studies in Watson and Downer (1996), Lyneham, O'Connor and Turner (1996) and Ainslie and Dickson (1997)
- John Dedman Parkway Preliminary Assessment: Maunsell Pty Ltd (1997)
- Recent traffic volume counts in the B11 and B12 Areas.

These studies collectively support the potential development provided in the B11 and B12 Areas. They provide the basis for determining that the traffic flows on streets in these areas will not increase above reasonable levels and will not significantly affect the level of residential amenity, having regard to the over-riding policy objective associated with urban consolidation.

Local Area Traffic Management devices (LATM's) are being installed as part of ongoing management program for these areas (such as the works constructed in David Street, Turner and Torrens Street Braddon). Other LATM's will be installed as necessary or as identified through the section master plan process.

Heritage issues

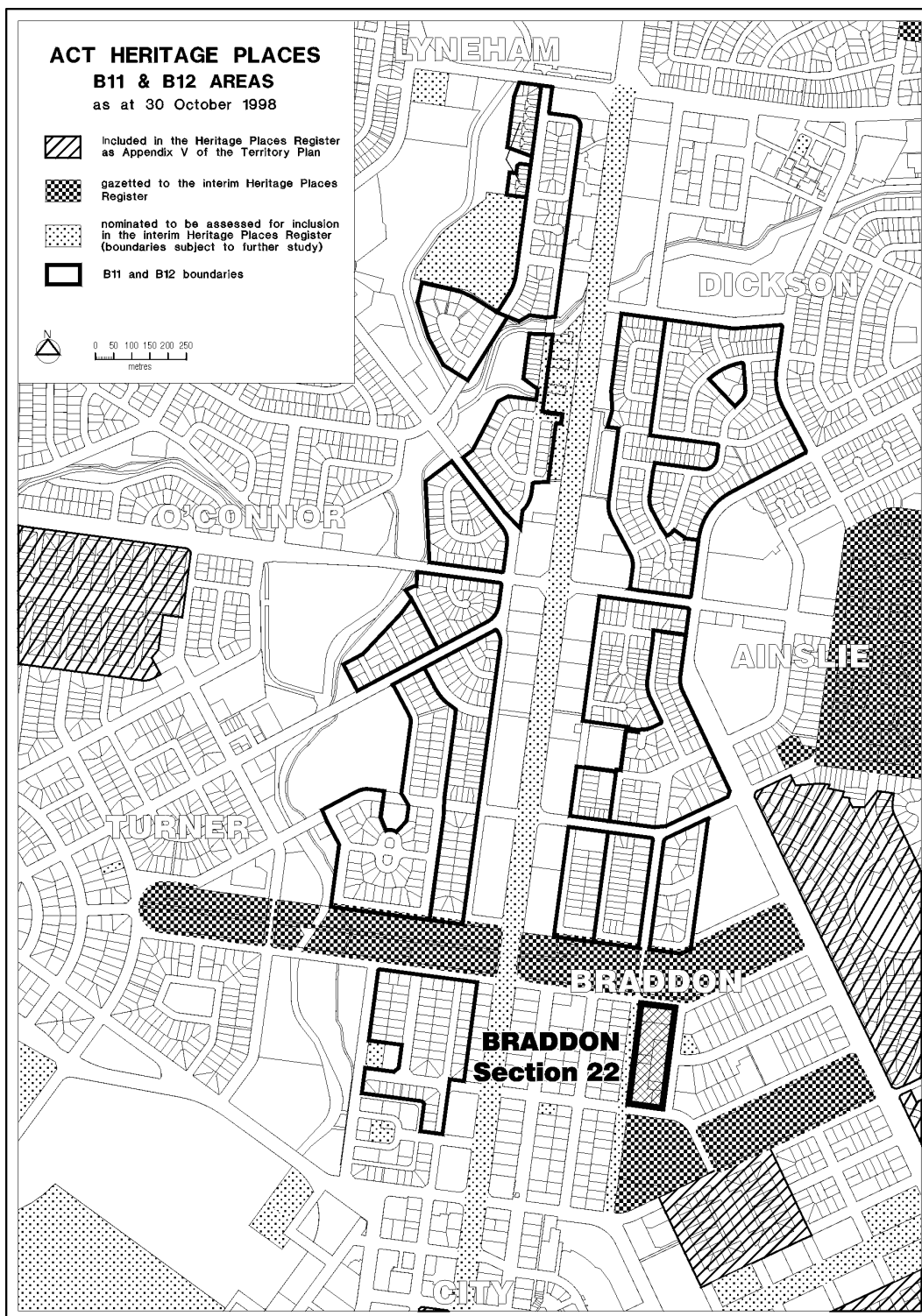

For this section there are no sites included on the

- Heritage Place Register (Appendix V of the Territory Plan)
- Gazetted in the Interim Heritage Places Register, or
- Nominated to be assessed for inclusion in the Heritage Places Register.

ANALYSIS

Relationship to Existing LAPAC, Community Value Statement

This section master plan has been prepared in the context of the Local Area Planning Advisory Committee (LAPAC) Area 3, “*Community Value Statement for Ainslie, Braddon, Reid and Campbell*,” 1996 (Note: while the boundaries of the LAPAC’s in north Canberra have changed, this Community Value Statement is still relevant to this area).

The section master plan is consistent with the urban design principles outlined at Attachment C, and a number of the specific values held by the community for the area including:

- *Community mix* - providing options for a range of dwelling types, sizes and locations, including variety of private gardens and private open space
- *Revitalisation of the suburbs* - encourages buildings to respond to existing built and landscape character. Sustainable building forms which address issues such as solar access, natural ventilation, energy efficiency, diversity, public amenity and safety, privacy are encouraged. Retention of amenity for lessees who do not wish to redevelop is addressed. Provides opportunities for a range of small scale commercial uses in appropriate locations.
- *Types and locations of residences* - encourages buildings to respond to existing built and landscape character. Sustainable building forms which address issues such as solar access, natural ventilation, energy efficiency, diversity, public amenity and safety, privacy are encouraged. Privacy between neighbours is addressed where appropriate.
- *Traffic* - minimising access to blocks along higher traffic volume roads, local area traffic management works and review of on-street parking provisions.
- *Security* - encourages dwelling types which maintain individual privacy between residents while providing active frontages to streets and passive surveillance from dwellings over public land. Generally provides for improvements to lighting of public areas
- *Streets and accessways* - the importance of the public realm (streets, paths, public places) is reinforced. Upgrades in the movement system are identified (ie. pedestrian paths/crossings, cycle paths etc)
- *Shops* - facilitates through increased population support for existing local centres, while providing additional (limited) opportunities for further small scale commercial uses, in integrated developments
- *Public open space amenities* - identifies elements which support the existing local open space, such as passive surveillance, pedestrian paths and lighting upgrades, etc
- *Heritage* - identifies the heritage requirements for the area
- *Habitat (flora/fauna)* - landscape character and themes supported
- *Impact of Area B1 (B11 and B12) development* - supports the minimising of impacts on residential amenity to areas outside the B11 and B12 Areas.

Existing Configuration



- Section 22 is bounded by Girrahween Street (north), Elouera Street (south), Torrens Street (west) and Fawknier (west)
- Haig Park is located directly to the North (across Girrahween Street)
- There are 7 blocks in the section. Five of these blocks have been constructed or are approved for redevelopment for three storey multi-dwelling uses.
- Blocks 21 and 22 contain single storey detached buildings

Existing vegetation

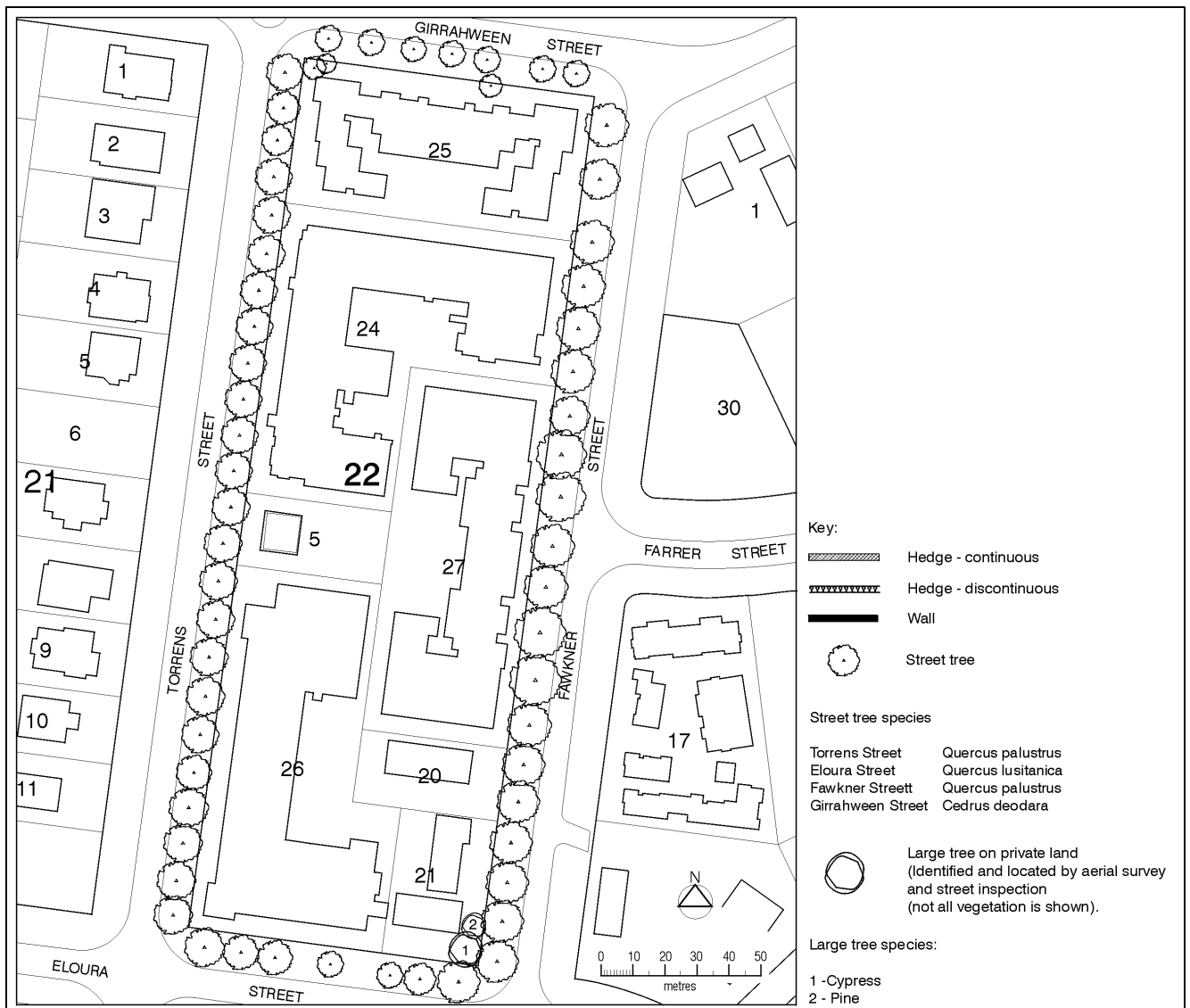

- Street trees are generally in good condition on the streets bounding the section
- Hedges provide an attractive frontage and privacy to a number of blocks (excluding Blocks 20 21) around the section.

Existing hydraulic services & electrical supply

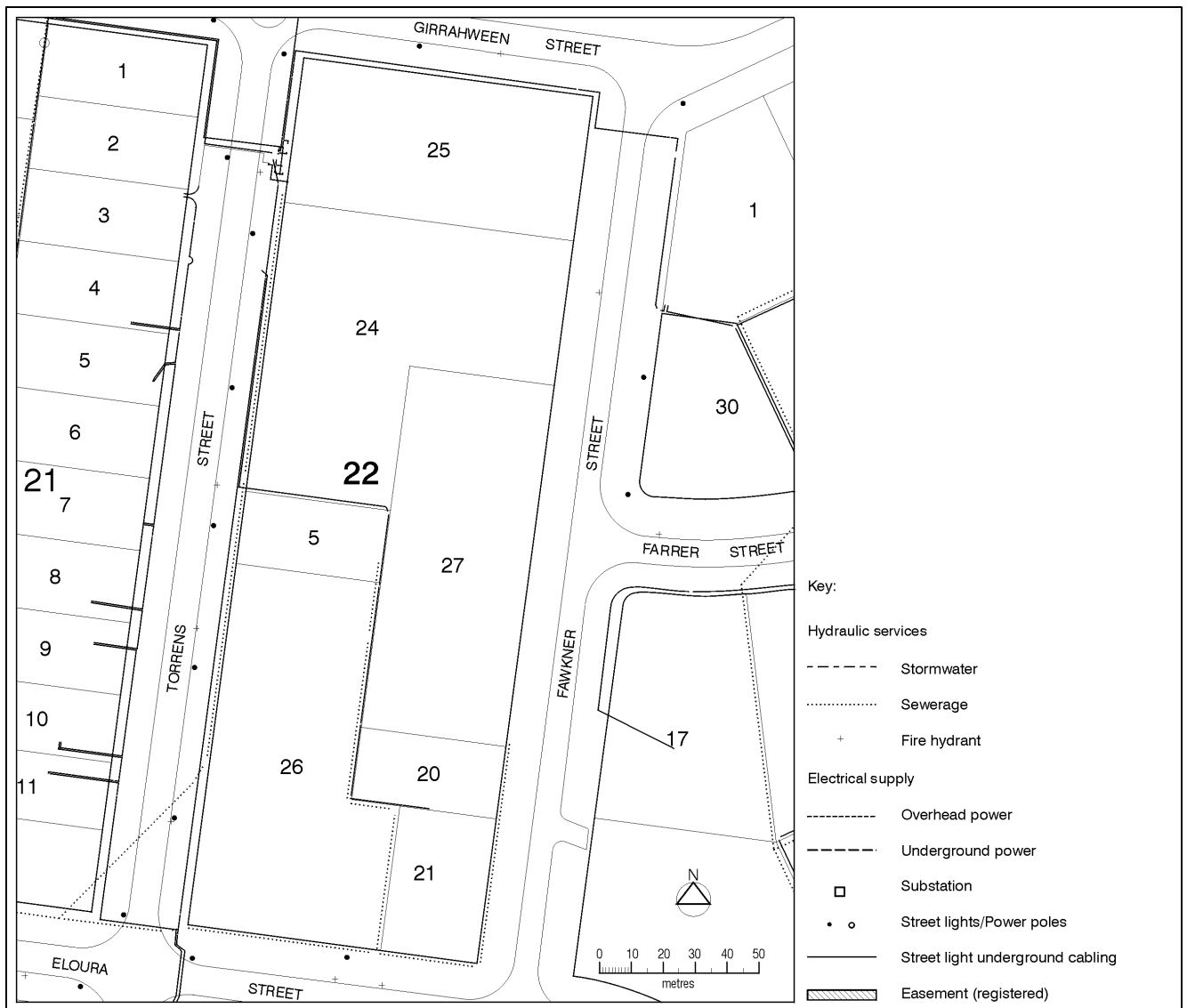

- Stormwater and sewerage are provided to the section. An easement for sewerage runs down the centre of the section along the rear of block boundaries.
- Street/pedestrian lighting is provided to streets surrounding the section.

Existing driveways, footpaths and street parking zones

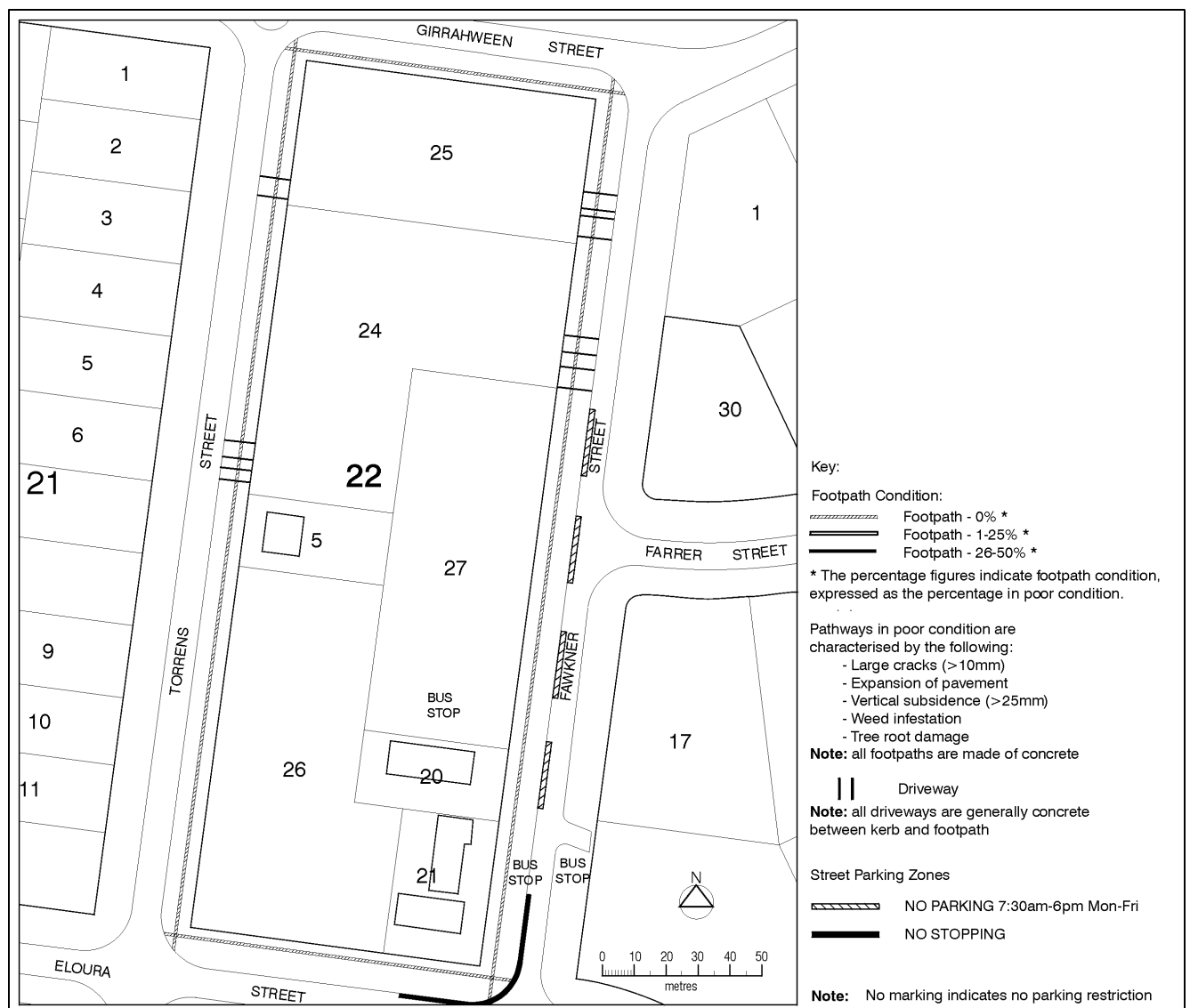

- The footpaths surrounding the section are generally in good condition.
- The footpath at the Fawkner Street and Eloura Street intersection is in poor condition
- There are parking restrictions on all the bounding streets.
- Bus stops are located on the eastern and western verges of Fawkner Street in front of Block 20.

Block and street dimensions



- The block depths of the two remaining blocks are both approximately 46 metres with widths of between 23 and 30 metres
- The blocks are regular in shape.
- A particular characteristic of Section 22 is a very wide verges, which contribute to the visual setback of dwellings from the road.

Known lessee information

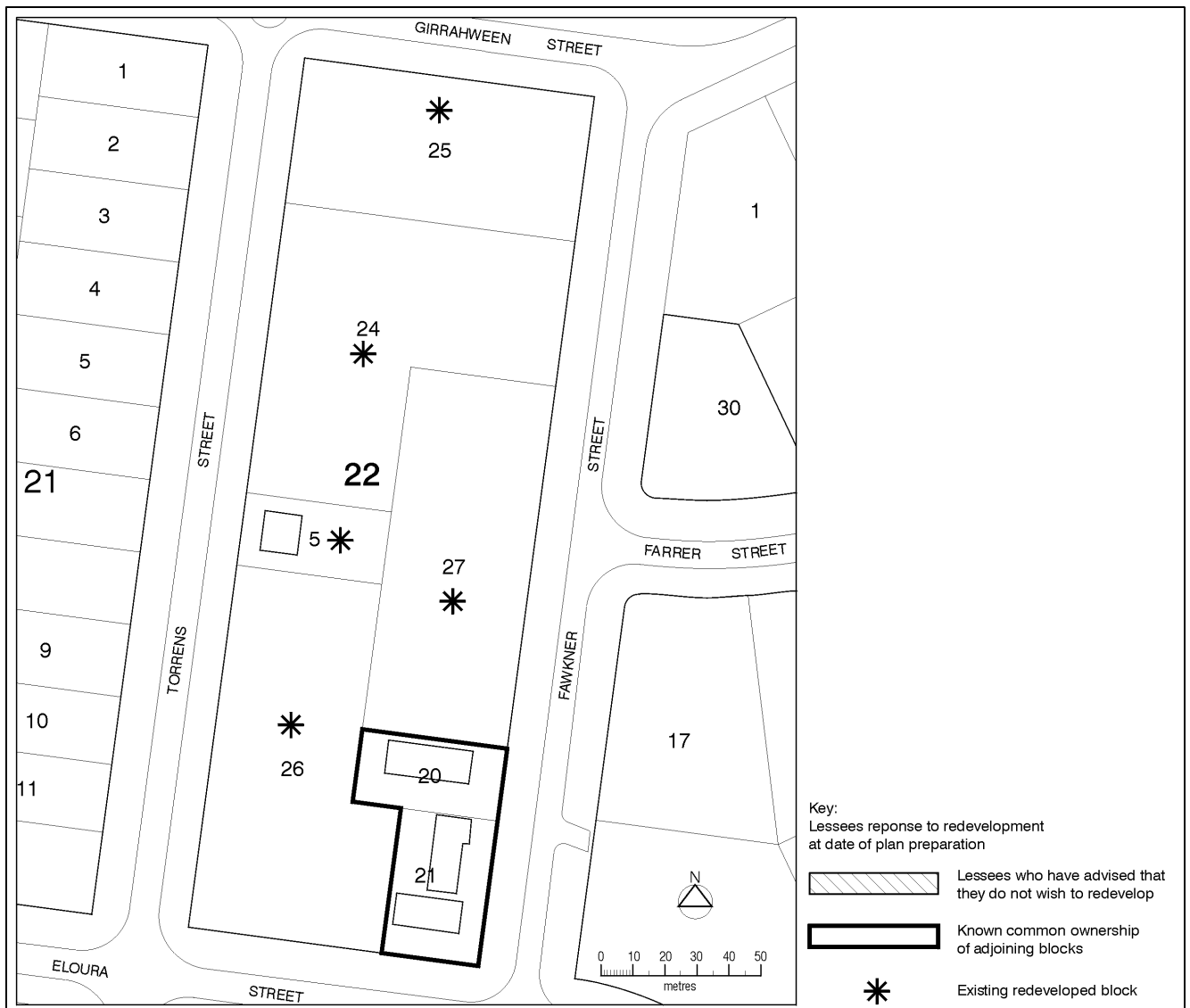

- The two remaining undeveloped blocks in Section 22 (Blocks 20 and 21) are in common ownership.

The development outcome drawing takes into account this information and indicates a possible development outcome for these blocks.

IMPLEMENTATION

Design criteria

Specific provisions of this Control Plan are “*Acceptable Standards*” under the Code.

The criteria used to produce the Control Plan for this section are as follows:

- Protect the amenity of existing residents
- Retain street trees
- Provide for planting and retention of medium to large trees with spreading crowns
- Provide passive surveillance of the street, Haig Park and Northbourne Oval
- Utilise existing driveway locations for vehicular access where possible
- Avoid garages dominating the street frontage
- Maximise street address for new dwellings
- Encourage dwelling entries to face the street
- Identify appropriate building types
- Identify appropriate parking provision
- Establish an appropriate streetscape.

Control Plan

The Control Plan is consistent with the Urban Design Principles at Attachment C and the above design criteria.

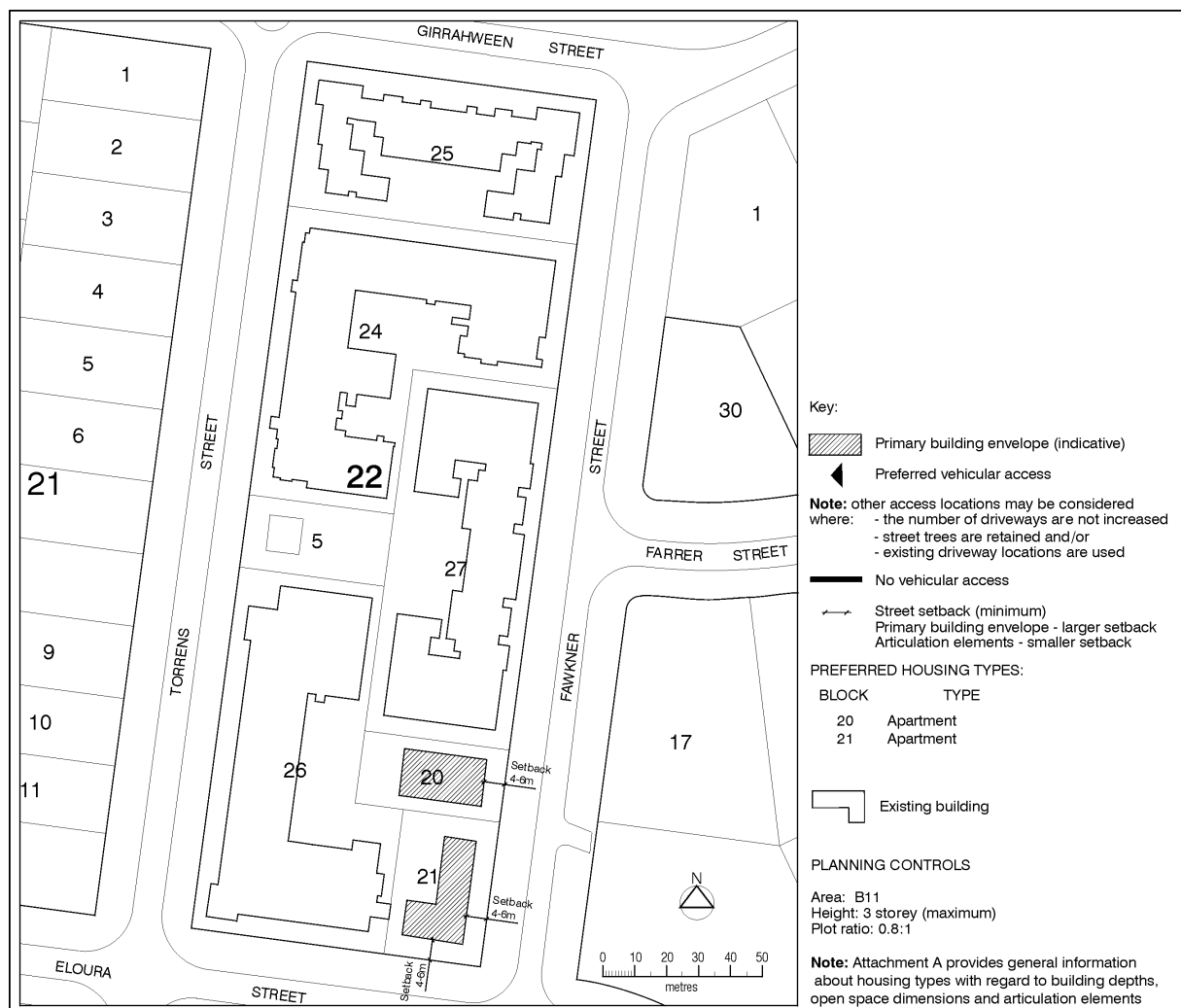

- **Setbacks**

The street setbacks have been established after consideration of site specific issues including; existing building locations, block orientation, existing vegetation, likely private open space location and existing features (such as fences, trees and hedges etc). The two street setback dimensions indicate the minimum setback and the minimum off-set to achieve vertical and horizontal articulation.

The following table sets out other minimum setbacks to the boundaries of adjoining existing developments. These setbacks are considered to meet the Performance Criteria of the Code (Daylight and Sunlight provisions - Section P6.6), and can be applied subject to the documented support of the adjoining lessee .

Section 22 Block	Acceptable standard
20	Setback to the northern boundary - GFL - 1.0m (min)* UFL (1) - 4.5m (min)** UFL (2) - 7.0m (min)** Setback to the western boundary - GFL - 1.0m (min)* UFL (1) - 4.5m (min)** UFL (2) - 7.0m (min)**
21	Setback to the western boundary - GFL - 1.0m (min)* UFL (1) - 3.0m (min)** UFL (2) - 5.0m (min)**
Notes:	Street setbacks are indicated on the Control Plan
	These setbacks apply only where there is written support for the proposal from the adjoining lessee, otherwise the Acceptable Standard A6.6.3 shall apply. Notwithstanding compliance with the above setbacks, the wall height and roof pitch of buildings shall minimise the overshadowing impact on adjoining blocks.
	Except where otherwise stated the Code applies
	Differences in building height between existing dwellings on the adjacent block and dwellings in new development (closest to those existing dwellings) are not more than one storey when viewed from the street, for the full length of the block.
	The above requirements (setback and building height) may be varied where the development intentions of the adjoining lessee changes, and that change (supporting the proposal) is documented as part of a development application
	GFL/UFL - means ground floor level/upper floor level
	* - to be blank walls, windows with high sill windows (minimum 1.7m high) or with obscure glazing or screen walls.
	** - overlooking provisions of the Code also apply.

- **Dual occupancies**

Where dual occupancy is proposed, the placement of buildings are to have regard for the Design Criteria and are to apply Housing Types 1, 2 or 9 (see Attachment A for details).

- **Parking**

The draft ACT Parking and Access Guidelines (October 1997) set out the objectives for the provision of parking and the minimum parking provision rates for developments. A lesser provision may be accepted if it can be demonstrated that the objectives can still be met by a lesser rate. Specifically, the guidelines allow for a reduction in rates where there is good accessibility to public transport and social, commercial use and employment etc.

The objectives for provision of parking and vehicular access in Residential Land Use Policy areas of the Territory Plan are to ensure:

- Amenity - is not unacceptably affected and design and siting requirements are met
- Safety – no traffic hazards are created by parking and access, safety of all users especially pedestrians and cyclist is considered and the surveillance of parking areas by people using neighbouring areas is created
- Efficiency – the parking generated does not unacceptably affect the efficient functioning of traffic and access to neighbouring areas and adequate parking is provided for the demand generated
- Access – is safe and efficient for residents and visitors
- Non-residential uses – the amenity of surrounding residential areas and the character of the streetscape will not be adversely affected by the provision of parking and access

This section is located in close proximity to:

- employment (particularly Civic, Braddon mixed use commercial area, education and research (ANU, CSIRO), Northbourne Avenue corridor
- commercial uses (shops, offices, services etc)
- community facilities (schools, child care, churches, health, open space etc), and
- trunk cycle paths.

In addition, the section has:

- good access to public transport
- some on-street parking restrictions to bounding streets, and
- generally a low vehicle speed environment.

These factors are considered to demonstrate that the objectives of the draft ACT Parking and Vehicular Access Guidelines are met by the following provision:

Resident parking (minimum)

- 1.0 space/unit for single bedroom dwellings (*this provision rate is consistent with the draft Guidelines*)
- 1.5 spaces/unit for dwellings with two or more bedrooms (*draft Guidelines provision rate is two spaces*), or
- 1.25 spaces/unit for two or more bedroom units if provision for more than one space is to be shared (*draft Guidelines provision rate is 1.5 spaces*)

- Visitor parking (*at the draft Guidelines rate of one space per four dwellings*) may be permitted on-street where short stay parking (two to three hours) traffic control devices are installed (*this locational requirement is consistent with the draft Guidelines*)
- **Block amalgamation or Integrated Development requirements**

Both of the remaining two undeveloped blocks are in common ownership. Notwithstanding this, the Control Plan generally allows any block to be redeveloped at any time.
- **Shared driveways and access ways**

Where shared driveways and internal access ways are proposed by one or more lessee's, they are required to:

 - be consistent with the Control Plan
 - vary their lease(s) to include clauses which address issues such as, elements to be provided (eg. lighting, landscaping), easements, access and maintenance.
- **Mixed use commercial**

Opportunities for mixed use commercial purposes are available to any developments subject to the provisions of draft Variation to the Territory Plan No:139 and which address the surrounding streets.

Development outcome drawing

(relative to Blocks 20 and 21)

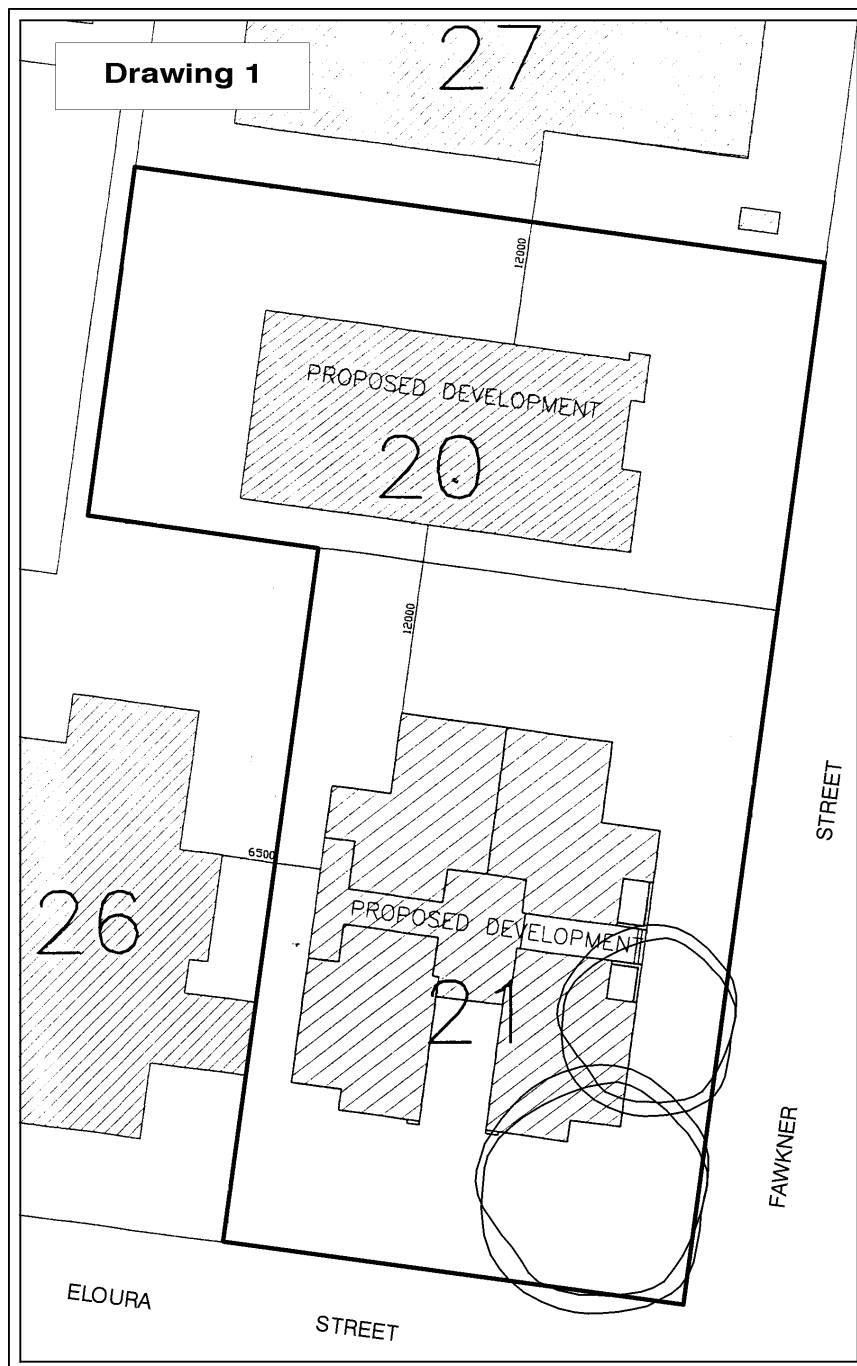

The following possible development outcomes drawing illustrates a possible outcome for the section when all the blocks are redeveloped, with consideration that five of the existing seven blocks are either constructed or approved for redevelopment

Required improvements to public and private areas

(relative to Blocks 20 and 21)



• Public areas

Proponents will be required to contribute to relevant elements of the following improvements as part of development approvals in this section.

- The footpath to the corner of Eloura Street and Fawcner Street is to be replaced – minimum 1.5m wide (concrete)
- The streetlights are to be upgraded
- Street trees are generally in good condition.
- Short stay parking (two to three hours) traffic control devices are to be installed to the satisfaction of the relevant authority
- Verge planting is to be grass and street trees, all other planting/ gardens (not approved) are to be removed
- Replacement driveways are to be in bitumen to reinforce the existing streetscape character

- **Private areas**

Landscape

Significant trees are to be retained. These trees have been identified by aerial photography and confirmed by street inspection. A comprehensive survey accurately locating all trees and hedges and assessing condition, value and life expectancy, will be required as part of the development application. The survey and report is to be undertaken and prepared by a suitably qualified person (eg. horticulturalist, arborist).

There are other large trees in the section which are not identified as “*significant trees to be retained*”. They include trees that are;

- not “significant” in neighbourhood or streetscape qualities
- in poor condition
- damaged or inappropriate form
- adversely affecting solar access of neighbouring dwellings, etc.

The long term retention of both significant and non-significant trees and other vegetation will be determined at the development application stage.

Side/rear boundary setback areas are to include screen planting.

Hedges should be retained. Establishment of further hedges (which may include gates) are encouraged. Shrub species proposed for hedges (replacement or extension) are not to be weed species.

Internal accessways

The predominant internal accessway surface is to be bitumen with unit pavers or concrete strips used to mark transition zones, parking bays, and pavement edges. Shared and visitor car spaces (where proposed) are to be distinguished from the internal accessway by a change of material.

Garbage enclosures

Garbage bin storage areas and enclosures are not to face public areas. These areas and structures are to be located to the rear of dwellings or incorporated into the building itself.